

178 SERIES

XM · SXM
XMA · SXMA
XMS · SXMS
XMV · SXMV
XM-M
XHW

HXM · HSXM
XM+F38
HYD-XM



Corpo e coperchi in alluminio pressofuso.

Coperchio posteriore con livello olio e scarico olio.

Bielle in lega zinco-alluminio pressofuso oppure in bronzo.

Testa in ottone stampato.

Pistoni in ceramica.

Possibilità di avere il corpo con trattamento di cataforesi (versione hot water).

Guarnizioni in PTFE (versione hot water).

Crankcase and back cover in pressure die-cast aluminium alloy.

Back cover incorporated with oil sight glass and oil drain outlet.

*Connecting rods in die-cast zinc-aluminium alloy.
Bronze connecting rods available.*

Pump head in forged brass.

Ceramic plungers.

Crankcase with cathoresis treatment (hot water version).

PTFE gasket sealing (hot water version).

178 Series

POMPA ALBERO MASCHIO
Solid shaft pump



idropultrici
pressure
washers

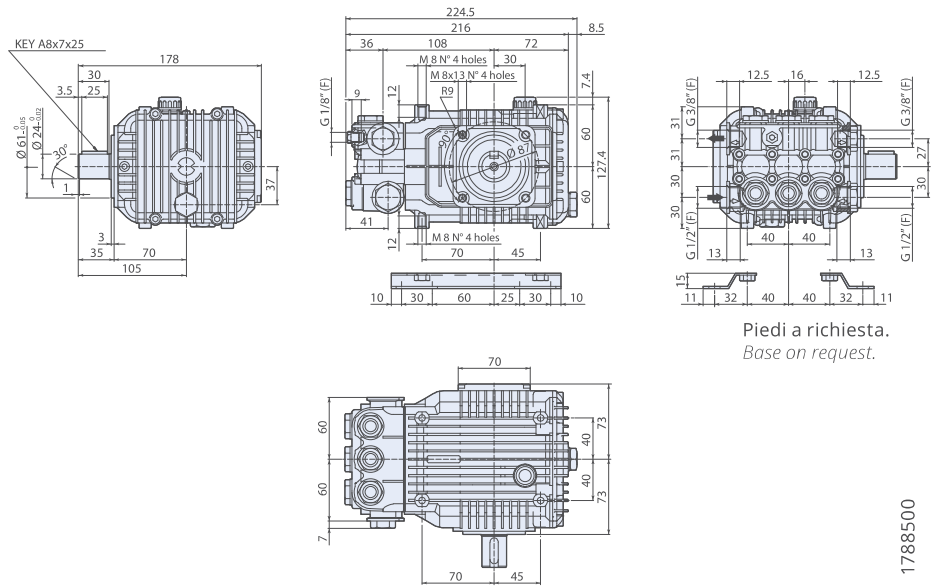

Piedi a richiesta.
Base on request.

1788500

N version

MOD	COD	MAX	MAX		NET				
		l/min	gpm	bar	psi	hp	kW	N° giri/1'	kg
XM 1450rpm Nversion Ø24mm									
XM 11.17 N	7900	11	2,90	170	2500	5	3,7	1450	6,5
XM 13.17 N	7902	13	3,43	170	2500	5,5	4	1450	6,5
XM 15.15 N	7906	15	3,96	150	2200	5,5	4	1450	6,5
SXM 1450rpm Nversion Ø24mm									
SXM 11.20 N	21374	11	2,90	200	2900	5,5	4	1450	6,5
SXM 13.20 N	21267	13	3,43	200	2900	7,5	5,5	1450	6,5
SXM 15.20 N	21265	15	3,96	200	2900	7,5	5,5	1450	6,5
XMS 2800rpm Nversion Ø24mm									
XMS 11.17 N	7908	11	2,90	170	2500	5	3,7	2800	6,5
XMS 13.17 N	7910	13	3,43	170	2500	5,5	4	2800	6,5
XMS 15.15 N	7912	15	3,96	150	2200	5,5	4	2800	6,5
XMS 15.20 N	20511	15	3,96	200	2900	7,5	5,5	2800	6,5
SXMS 2800rpm Nversion Ø24mm									
SXMS 11.20 N	21376	11	2,90	200	2900	5,5	4,1	2800	6,5
SXMS 13.20 N	21257	13	3,43	200	2900	7,5	5,5	2800	6,5
SXMS 15.20 N	21258	15	3,96	200	2900	7,5	5,5	2800	6,5



testa in
ottone
brass
head



bielle in
bronzo
bronze
connecting-rods



bielle in
alluminio
aluminium
connecting-rods



178 Series

POMPA ALBERO MASCHIO Solid shaft pump



idropulitrici
pressure
washers

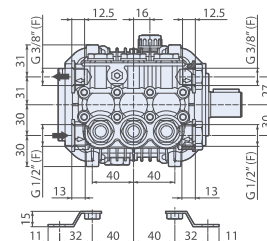
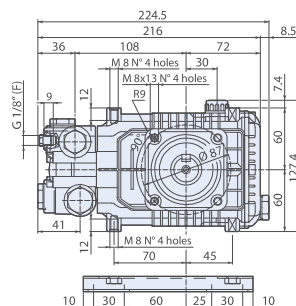
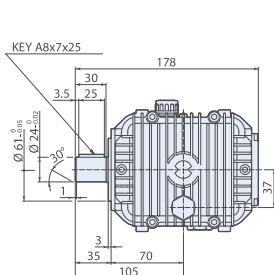

Piedi a richiesta.
Base on request.

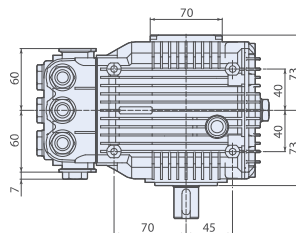

1788500

N version

MOD	COD	MAX	MAX	MAX	MAX	MAX	MAX	MAX	NET
		l/min	gpm	bar	psi	hp	kW	N° giri/1'	kg
XMA 1750rpm Nversion Ø24mm									
XMA 3 G25 N	7916	11,4	3	170	2500	5	3,7	1750	6,5
XMA 3.5 G22 N	7918	13,2	3,5	150	2200	5	3,7	1750	6,5
XMA 3.5 G25 N	7920	13,2	3,5	170	2500	5,5	4	1750	6,5
XMA 4 G20 N	7922	15,1	4	140	2000	5,5	4	1750	6,5
SXMA 1750rpm Nversion Ø24mm									
SXMA 3 G30 N	21401	11,4	3	205	3000	5,5	4	1750	6,5
SXMA 3.5 G30 N	21406	13,2	3,5	205	3000	7	5,2	1750	6,5
SXMA 4 G30 N	21261	15,1	4	205	3000	7,5	5,5	1750	6,5
XMV 3400rpm Nversion Ø24mm									
XMV 3 G30 N	20529	11,4	3	205	3000	5,5	4	3400	6,5
XMV 3.5 G25 N	7928	13,2	3,5	170	2500	5,5	4	3400	6,5
XMV 4 G22 N	7932	15,1	4	150	2200	5,5	4	3400	6,5
XMV 4 G30 N	20849	15,1	4	205	3000	7,5	5,5	3400	6,5
SXMV 3400rpm Nversion Ø24mm									
SXMV 3 G35 N	21379	11,4	3	240	3500	7,5	5,5	3400	6,5
SXMV 3.5 G35 N	21380	13,2	3,5	240	3500	10	7,5	3400	6,5
SXMV 4 G35 N	21263	15,1	4	240	3500	10	7,5	3400	6,5



testa in
ottone
brass
head



bielle in
bronzo
bronze
connecting-rods



bielle in
alluminio
aluminium
connecting-rods

178 Series

POMPA ALBERO CAVO
Hollow shaft pump



idropulitrici
pressure
washers

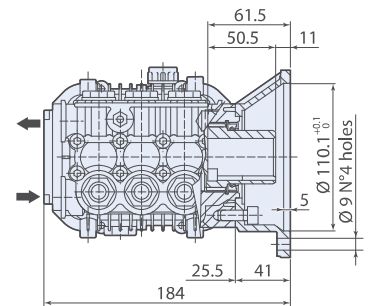
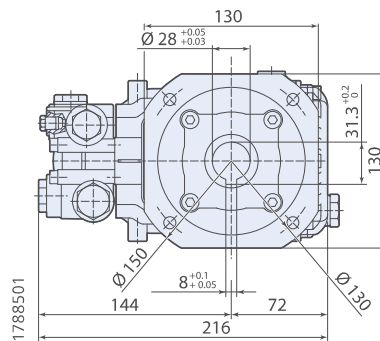

Flangia F16 fornita a richiesta.
F16 flange on request.

C version

MOD	COD	MAX		MAX		MAX		N° giri/1'	kg
		l/min	gpm	bar	psi	hp	kW		
XM 1450rpm Cversion Ø28mm									
XM 11.17 C	7936	11	2,90	170	2500	5	3,7	1450	6,5
XM 13.17 C	7938	13	3,43	170	2500	5,5	4	1450	6,5
XM 15.15 C	7942	15	3,96	150	2200	5,5	4	1450	6,5
SXM 1450rpm Cversion Ø28mm									
SXM 11.20 C	21375	11	2,90	200	2900	5,5	4	1450	6,5
SXM 13.20 C	21255	13	3,43	200	2900	7,5	5,5	1450	6,5
SXM 15.20 C	21256	15	3,96	200	2900	7,5	5,5	1450	6,5
XMS 2800rpm Cversion Ø28mm									
XMS 11.17 C	7944	11	2,90	170	2500	5	3,7	2800	6,5
XMS 13.17 C	7946	13	3,43	170	2500	5,5	4	2800	6,5
XMS 15.15 C	7948	15	3,96	150	2200	5,5	4	2800	6,5
SXMS 2800rpm Cversion Ø28mm									
SXMS 11.20 C	21377	11	2,90	200	2900	5,5	4	2800	6,5
SXMS 13.20 C	21259	13	3,43	200	2900	7,5	5,5	2800	6,5
SXMS 15.20 C	21260	15	3,96	200	2900	7,5	5,5	2800	6,5

Flangia F16 per motori elettrici B14 Gr.100÷112 IEC34-7, 50Hz. Flangia non inclusa.
F16 flange for electric motor B14 100÷112 IEC34-7, 50Hz. Flange not included.





178 Series

POMPA ALBERO CAVO Hollow shaft pump



idropultrici
pressure
washers

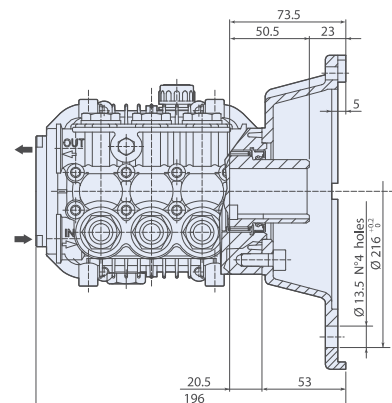
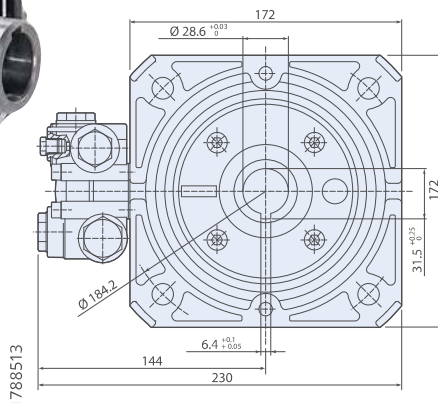

Flangia F17 fornita a richiesta.
F17 flange on request.

E version

MOD	COD	MAX	MAX	MAX	MAX				
		l/min	gpm	bar	psi	hp	kW	N° giri/1'	kg
XMA 1750rpm Eversion Ø 1" 1/8									
XMA 3 G25 E	7952	11,4	3	170	2500	5	3,7	1750	6,5
XMA 3.5 G25 E	7956	13,2	3,5	170	2500	5,5	4	1750	6,5
XMA 4 G20 E	7958	15,1	4	140	2000	5,5	4	1750	6,5



testa in
ottone
brass
head



bielle in
alluminio
aluminium
connecting-rods

Flangia F17 per motori elettrici NEMA 182-184, 4 poli 60Hz. Flangia non inclusa.
F17 flange for electric motor NEMA 182-184, 4 poles 60Hz. Flange not included.

POMPA ALBERO CAVO Hollow shaft pump



idropultrici
pressure
washers

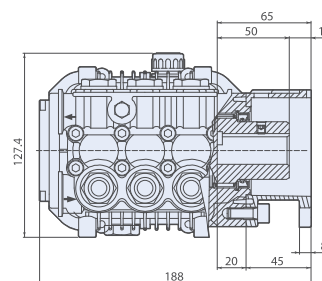
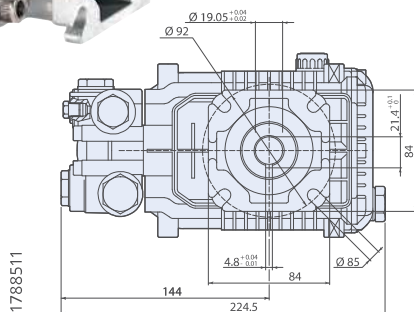

Flangia F25 fornita a richiesta.
F25 flange on request.

D version + F25

MOD	COD	MAX	MAX	MAX	MAX				
		l/min	gpm	bar	psi	hp	kW	N° giri/1'	kg
XMV 3400rpm Eversion + F25 Ø 3/4"									
XMV 3 G30 D + F25	20095	11,4	3	205	3000	5,5	4	3400	7
XMV 3.5 G25 D + F25	7996	13,2	3,5	170	2500	5,5	4	3400	7



testa in
ottone
brass
head



bielle in
alluminio
aluminium
connecting-rods

Flangia F25 per motori scoppio Ø 3/4" SAE J609a. Flangia inclusa.
F25 flange for gasoline engine Ø 3/4" SAE J609a. Flange included.

178 Series

POMPA ALBERO CAVO Hollow shaft pump



idropultrici
pressure
washers

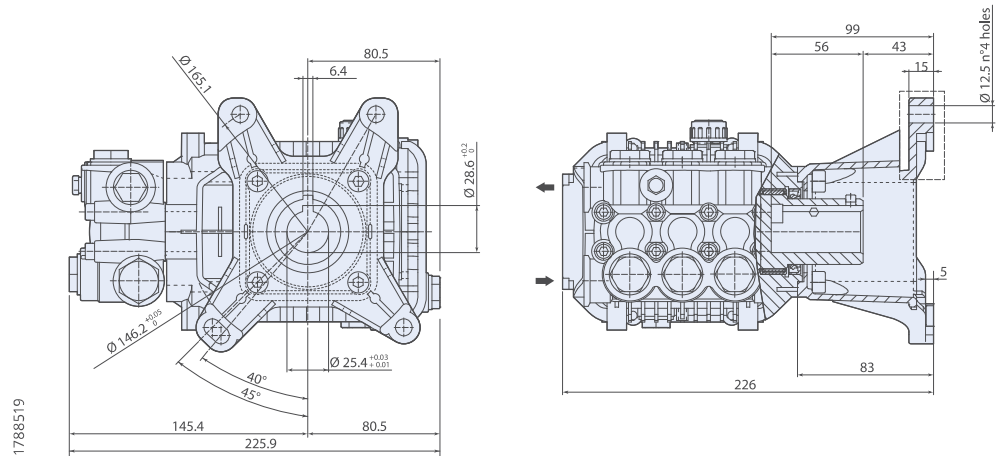

D version + F40

MOD	COD	MAX		MAX		N°		kg	
		l/min	gpm	bar	psi	hp	kW		giri/1'
XMV 3400rpm Dversion + F40 Ø1"									
XMV 3 G30 D + F40	20111	11,4	3	205	3000	5,5	4	3400	7
XMV 3.5 G30 D + F40	21128	13,2	3,5	205	3000	7	5,2	3400	7
XMV 4 G25 D + F40	7990	15,1	4	170	2500	7	5,2	3400	7
XMV 4 G30 D + F40	20820	15,1	4	205	3000	7,5	5,5	3400	7
SXMV 3400rpm Dversion + F40 Ø1"									
SXMV 3 G35 D + F40	21381	11,4	3	240	3500	7,5	5,5	3400	7
SXMV 3.5 G35 D + F40	21382	13,2	3,5	240	3500	8,5	6,2	3400	7
SXMV 4 G35 D + F40	21264	15,1	4	240	3500	10	7,5	3400	7

Flangia F40 per motori scoppio Ø 1" SAE J609a. Flangia inclusa.
F40 flange for gasoline engine Ø 1" SAE J609a. Flange included.



testa in
ottone
brass
head



bielle in
bronzo
bronze
connecting-rods



bielle in
alluminio
aluminium
connecting-rods



178 Series

POMPA ALBERO MASCHIO Solid shaft pump



misting

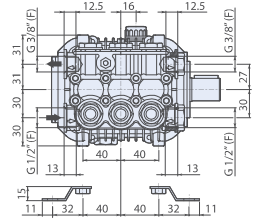
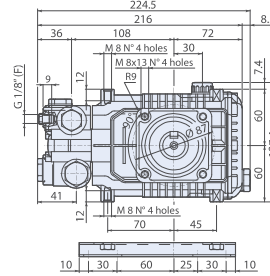
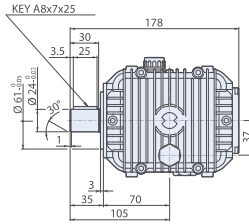

Piedi a richiesta.
Base on request.

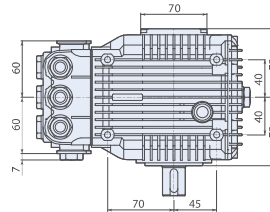

N version

MOD	COD	MAX	MAX		NET						
		l/min	gpm	bar	psi	hp	kW	N° giri/1'	kg		
XM-M 1450rpm Nversion Ø24mm											
XM-M 01.10 N	22092	1	0,26	100	1450	0,3	0,2	1450	6,5		
XM-M 02.10 N	22093	2	0,52	100	1450	0,5	0,4	1450	6,5		
XM-M 04.10 N	22094	4	1,06	100	1450	1	0,8	1450	6,5		
XM-M 08.10 N	22095	8	2,11	100	1450	2	1,5	1450	6,5		



testa in ottone
brass head



bielle in alluminio
aluminium connecting-rods

1788500

POMPA ALBERO MASCHIO Solid shaft pump

HOT WATER 85°C

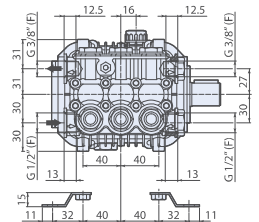
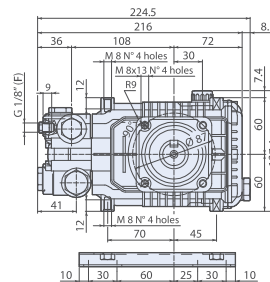
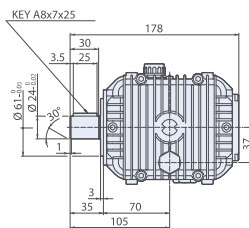
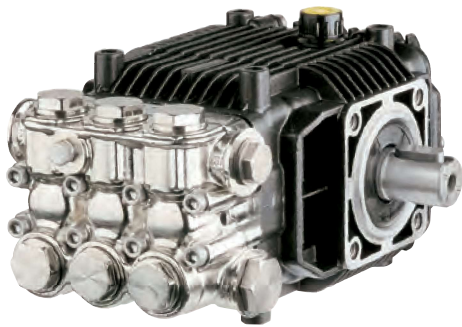

Piedi a richiesta.
Base on request.

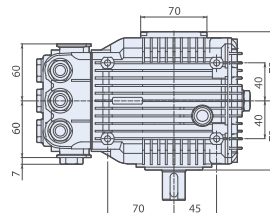

autolavaggio municipality
car wash

N version

MOD	COD	MAX	MAX		NET						
		l/min	gpm	bar	psi	hp	kW	N° giri/1'	kg		
XHW 1450rpm Nversion Ø24mm											
XHW 08.15 N	23972	8	2,11	150	2200	3	2,2	1450	6,5		
XHW 11.17 N	22543	11	2,90	170	2500	5	3,7	1450	6,5		



testa nichelata
nickel plated brass head



guarnizioni in PTFE
PTFE gasket sealing



bielle in bronzo
bronze connecting-rods

1788500



idropultrici
pressure
washers



GR. 112 motor hollow shaft

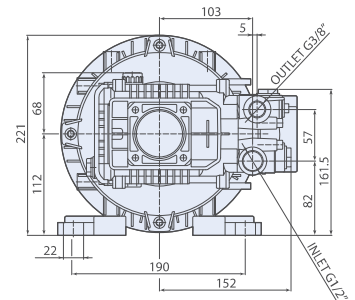
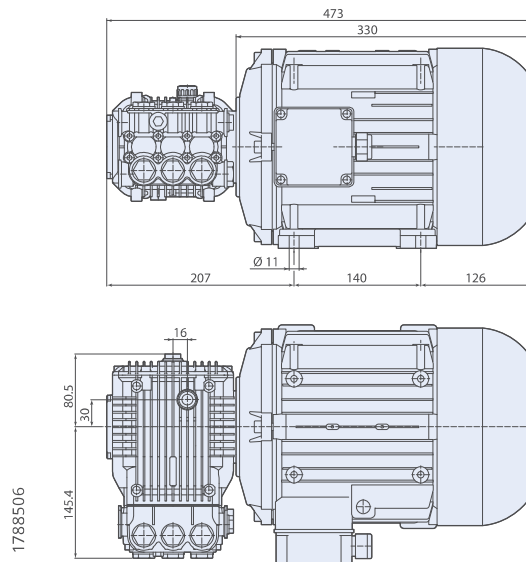

MOD	COD	MAX		MAX						KG	
	3 ~	l/min	gpm	bar	psi	hp	kW	N° giri/1'	V 3-50Hz	Gr.	kg
HXM - HSXM 1450rpm											
HXM 13.17 ET	20196	13	3,43	170	2500	5,5	4	1450	230/400	112	30
HSXM 13.20 ET	21370	13	3,43	200	2900	7,5	5,5	1450	230/400	112	38
HXM 15.15 ET	20197	15	3,96	150	2200	5,5	4	1450	230/400	112	30
HSXM 15.20 ET	21371	15	3,96	200	2900	7,5	5,5	1450	230/400	112	37,7



testa in
ottone
brass
head



bielle in
bronzo
bronze
connecting-rods



bielle in
alluminio
aluminium
connecting-rods



3~50Hz
frequenza
motore
motor
frequency



178 Series

GASOLINE MOTOR-PUMP UNITS



idropultrici
pressure
washers

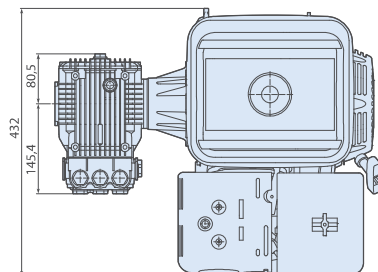
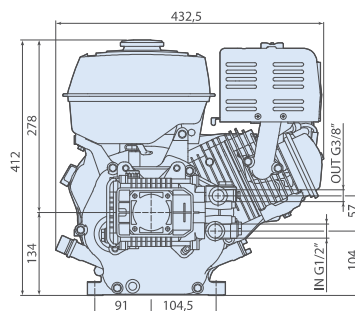
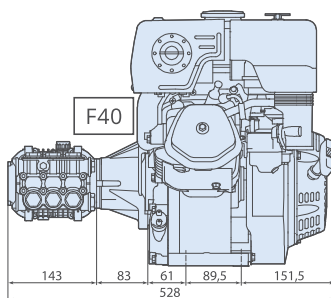
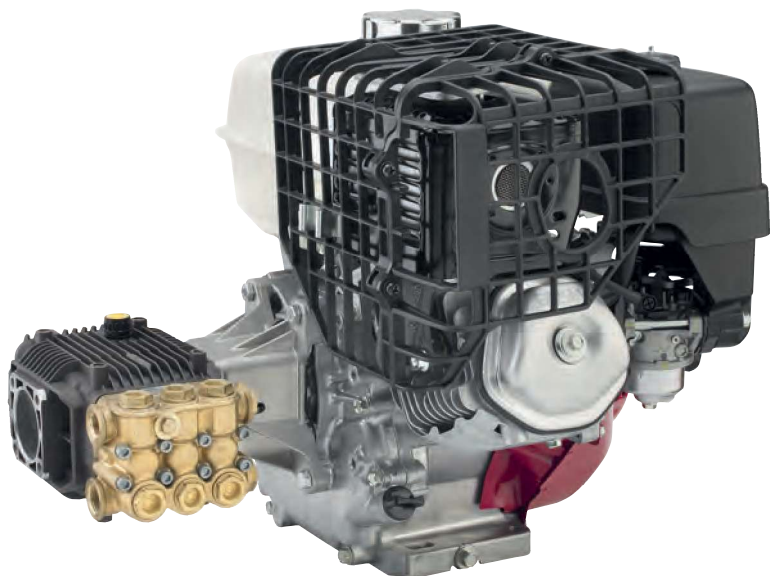

1788538

MOD	COD	MAX	MAX	RPM	NET			
		l/min	gpm	bar	psi	N° giri/1'	kg	
XMV Direct Drive								
XMV 4 G20 HONDA GX 270-QX Type	8,4	20237	15,1	4	140	2000	3400	32



testa in
ottone
brass
head



bielle in
alluminio
aluminium
connecting-rods



motore a
scoppio
gasoline
engine

178 Series

HYDRAULIC DRIVE



municipality

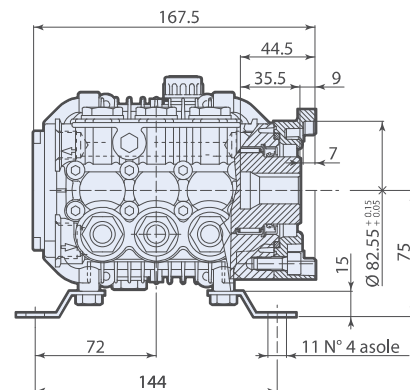
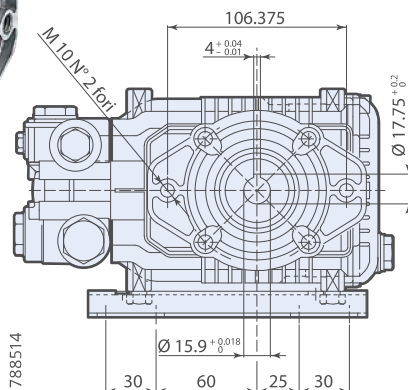

Piedi a richiesta.
Base on request.

XM + F38

MOD	COD	MAX	gpm	MAX	psi	hp	kW	N° giri/1'		NET	kg
XM 1450rpm + F38											
XM 15.15 + F38	21598	15	3,96	150	2200	5,5	4	1450	6,7		



testa in ottone
brass head



bielle in alluminio
aluminium connecting-rods



HYDRAULIC DRIVE



municipality

USCITA / ENTRATA SIDE INLET / OUTLET PORT G 3/4" (THD 16 mm deep)

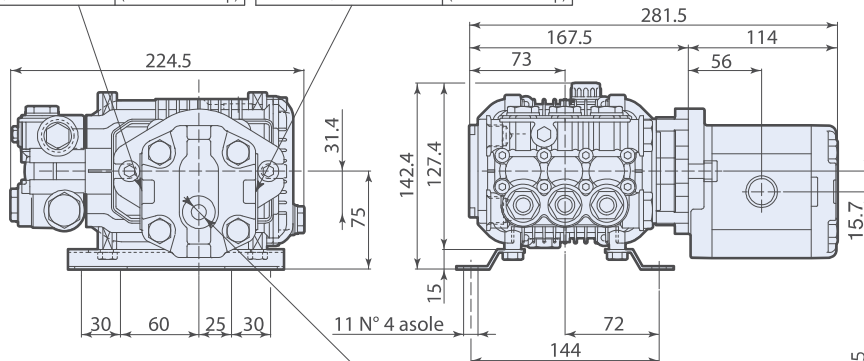

DRENAGGIO DRAIN PORT G 1/4" (THD 13 mm deep)



testa in ottone
brass head



bielle in alluminio
aluminium connecting-rods



motore idraulico
hydraulic drive

HYD - XM

MOD	COD	POMPA A PISTONI • HP PISTON PUMP						MOTORE IDRAULICO • HYDRAULIC MOTOR						NET
		MAX	gpm	MAX	psi	RPM	hp	SAUER DANFOSS	MAX	MAX	RPM	kg		
		l/min	gpm	bar	psi	N° giri/1'	hp	Type	Cod	cm ³	bar	l/min	N° giri/1'	kg
HYD-XM														
HYD-XM 15.15	21603	15	3,96	150	2200	1450	5,5	SNM2NN/019 BN06GAM1F5F5N	4769	19,2	105	29	1450	9,6

1788515